



# DC PUMPS BIPUMP

**EN.** Fuel vane pumps. Displacement, rotary vane pumps for transferring diesel fuel, characterized by high flow rates. Available in 12 and 24 Volt versions.

Technical features:

Vane pump with rotor. By-pass valve incorporated into the pump body. Working cycle of 30 min. Integrated On/Off switch. Flanged 1" connectors.

**ES.** Bombas de paletas para transferencia. Bomba rotativa de paletas para el trasiego de diésel, caracterizada por su caudal elevado. Disponible en versiones 12V y 24V.

Características técnicas:

- Bomba de paletas con rotor.  
- Válvula de bypass incorporada.  
- Ciclo de trabajo de 30 min.  
- Interruptor y conexiones hembras de 1".

**PT.** Bombas com palhetas para transferência. Bomba de tipo rotativo volumétrico com palhetas para transferência de óleo diesel, caracterizada por alta capacidade. Disponíveis em versões de 12 e 24 Volts.

Características técnicas:

Bomba do tipo com palhetas e rotor. Válvula by-pass incorporada no corpo da bomba. Ciclo de trabalho de 30 min. Interruptor on/off integrado. Encaixes com flange de 1".

## PERFORMANCE

- Flow rate up to 85 l/min  
- 12 - 24 V DC operation  
- Duty cycle 30 min.

- Caudal de hasta 85 l/min  
- Versiones 12V y 24V CC  
- Ciclo de funcionamiento 30 min.

- Caudal até 85 l/min  
- Funcionamento 12 - 24 V DC  
- Ciclo de trabalho 30 min.

## DIMENSIONS

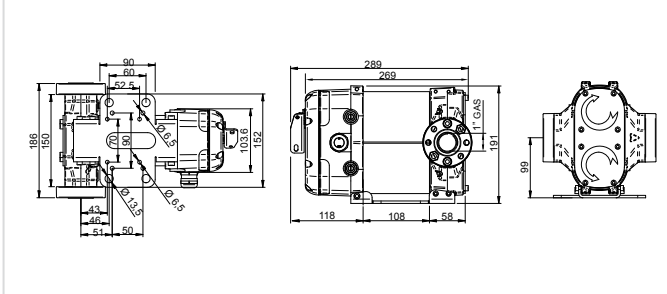

## GUARANTEE



IP Protection  
Guaranteed

**Guaranteed IP55 protection**  
Prevents water and dust entering the motor.

## PRODUCTS' RANGE WEIGHT AND PACKAGING

Code	Weight		Packaging		
	kg	lbs	mm	inch	pcs/box
F00363A0A	9,9	21,8	345x175x255	13,6x6,9x10	1
F00363B0A	9,9	21,8	345x175x255	13,6x6,9x10	1
F0036301A	10,2	22,5	345x175x255	13,6x6,9x10	1
F0036302A	10,4	22,5	345x175x255	13,6x6,9x10	1
F0036303A	10,2	22,5	345x175x255	13,6x6,9x10	1
F0036304A	10,4	22,5	345x175x255	13,6x6,9x10	1
F0036321A	8,5	18,7	345x175x255	13,6x6,9x10	1



**Flow-rate**

up to  
**85** l/min  
(up to 22,4 gpm)



Bipump

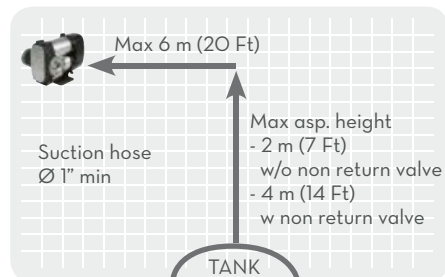
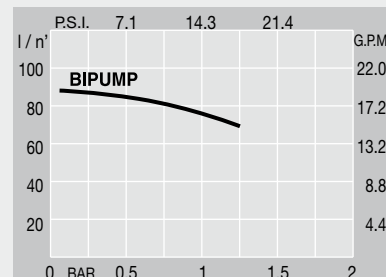

**FEATURES**

**On/Off switch**



**Flanged connect.**



**ON REQUEST**

**Kit Carry**



**PRODUCTS' RANGE TECHNICAL DATA**

Code	Description	Fluids type	Flow-rate		Voltage			Duty cycle min.	rpm	Meter mod.	Inlet BSP
			l/min	gpm	DC Volt	Power Watt	Amp. max.				
F00363A0A	Bipump 12V with on/off switch	D	85	22,4	12	500	42	30	2000	K44	1"1/2
F00363B0A	Bipump 24V with on/off switch	D	85	22,4	24	500	21	30	2000	K44	1"1/2
F0036301A	Bipump 12V with cable 2 m	D	85	22,4	12	500	42	30	2000	K44P	1"1/2
F0036302A	Bipump 12V with cable 4 m	D	85	22,4	12	500	42	30	2000	K44P	1"1/2
F0036303A	Bipump 24V with cable 2 m	D	85	22,4	24	500	21	30	2000	K44	1"1/2
F0036304A	Bipump 24V with cable 4 m	D	85	22,4	24	500	21	30	2000	K44	1"1/2
F0036321A	Bipump 12/24 without on/off switch	D	85	22,4	12/24	500/500	42/21	30/30	2000	K44P	1"1/2
R14334000	Kit cable 2 m										
R14335000	Kit cable 4 m										
F14200000	Kit handle										