



Meggitt Fuelling Products

Avery-Hardoll
Whittaker Controls

1.5 in. Sampling, vent or drain valve GBMY3806M2

IOM with spare parts

Publication ref TP0040
Issue 3 November 2000

Avery-Hardoll
Holland Way
Blandford Forum
Dorset DT11 7BJ
UK

Tel: +44 (0) 1258 486600
Fax: +44 (0) 1258 486601

www.meggittfuelling.com

Whittaker Controls
12838 Saticoy St
North Hollywood
California 91605-3505
USA

Tel: +1 818 765 8160
Fax: +1 818 759 2194

www.wkr.com
www.meggitt.com

The information contained herein is the property of Avery Hardoll a division of Meggitt (UK) Ltd. No part may be reproduced or used except as authorised by contract or other written permission. The Company reserves the right to alter without notice the specification, design or conditions of supply of any product or service.

MEGGITT
smart engineering for
extreme environments

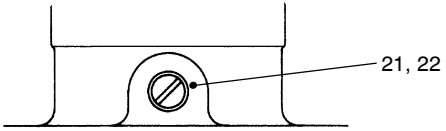

SCRAP DETAIL ON ARROW A

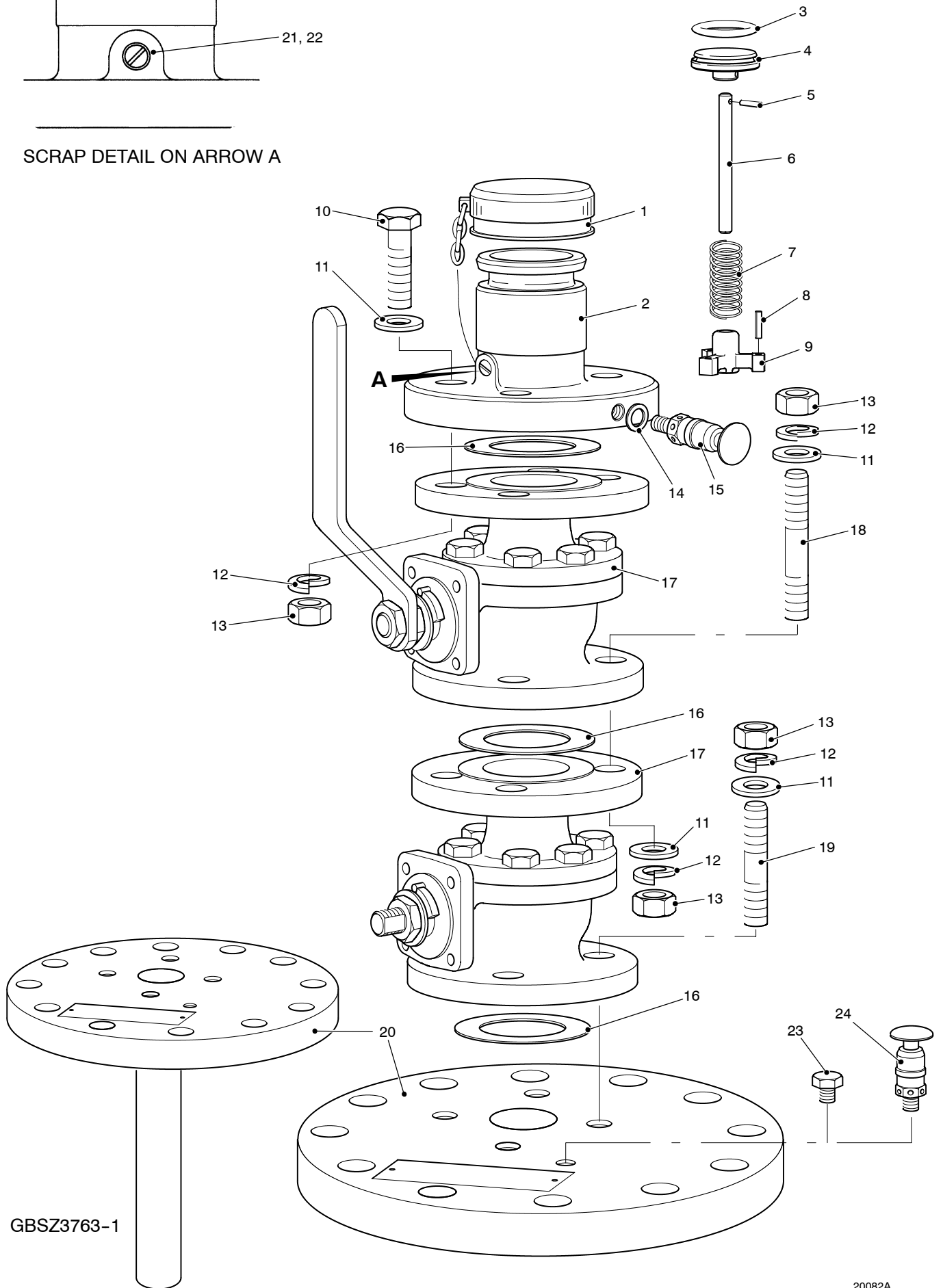

1 1/2 inch INCH SAMPLING VALVE (INTERNAL) S/ASSY

1½ INCH SAMPLING VALVE (INTERNAL) S/ASSY**GBMY3806M2-1 1½ INCH UNIT WITH SINGLE BLEED VALVE****GBMY3806M2-2 1½ INCH UNIT WITH DOUBLE BLEED VALVE**

<u>ITEM</u>	<u>PART NO.</u>	<u>DESCRIPTION</u>	<u>QTY</u>
1	CCMY4VN	1½ inch Blanking Cap Assy.	1
2	CCMY8156-1	1½ inch St. St. Tank Unit (Extended) + Drilled	1
* 3	ZO32E220139A	'O' Ring (Viton)	1
4	CCSZ8171	Valve	1
5	ZT4001MF416A	Tension Pin	1
6	CCSZ8172	Valve Stem	2
7	CCSZ223	Spring	1
8	ZT4012M0316A	Groove Pin	1
9	CCSZ8173	Valve Guide	1
10	ZS3226D2036A	Bolt 5/8 inch - 11 UNC x 2¼ inches long	4
11	ZW2201G20A	Washer 5/8 inch Plain	16
12	ZW8207G20A	Spring Washer ½ inch single coil	16
13	ZN2201D20A	Nut 5/8 inch -11 UNC	16
14	ZMMZ0135-9	¼ inch Dowty Sealing Washer	1
15	ZMMZ0320-04	Pressure relief / Bleed valve 200psi, UNF	1
16	GBFZ3772	Gasket	3
17	ZAMZ0302-9	Firesafe Ball Valve Assembly complete	2
18	ZASZ0028-29	Stud 5/8 inch - 11 UNC x 3¾ inch long	4
19	ZASZ0028-17	Stud 5/8 inch - 11 UNC x 2½ inch long	4
20	GBSZ3763	Base flange	1
	GBSZ3763-1	Base flange with 1½ inch pipe	1
21	ZS4005M05008A	Screw pan head M5	1
22	ZW4006M05A	Washer M5 Shakeproof	1
23	ZACZ0017-13	Plug ¼ inch BSPT (GBMY3806M2-1 only)	1
24	ZMMZ0320-05	Pressure relief / Bleed valve 200psi, BSPT (GBMY3806M2-2 only)	1

* = Suggested spares.

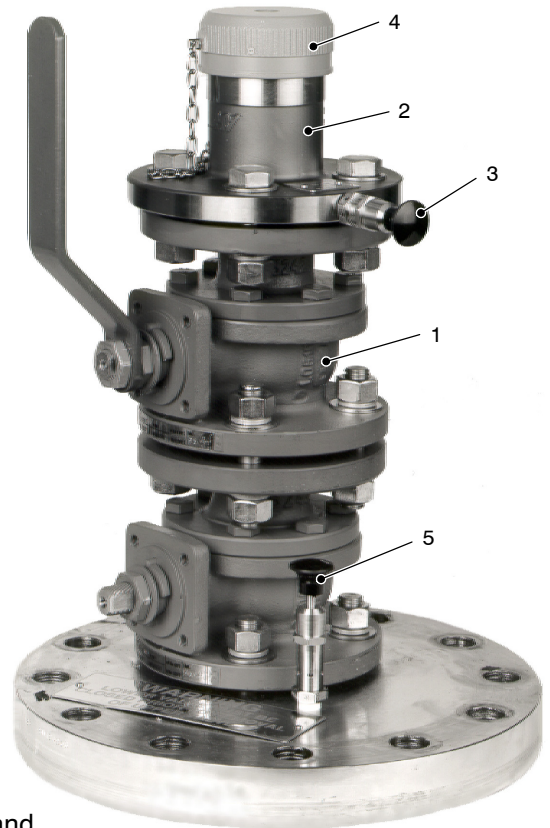

Operating procedure

- 1 Ensure that the block valve (1) is fully closed.
- 2 Vent tank unit (2) via the pressure relief/bleed valve (3).
- 3 Remove the blanking cap (4).
- 4 Connect 1¹/₂ inch hose unit to the tank unit (2).
- 5 Open the block valve (1)
- 6 Take the required sample.
- 7 Fully close the block valve.
- 8 Disconnect the hose unit.
- 9 Replace the blanking cap.
- 10 Avery-Hardoll undertake to supply this unit only on the basis of the customers acceptance of the above operating procedure. Such procedure is to be displayed in the pit and to be fully visible to the operator.

Hydrostatic pressure testing procedure

- 1 Remove 1¹/₂ inch tank unit (2)
- 2 Remove pressure relief valve (5) if fitted and plug the hole with a 1/4 in. BSP taper plug part no. ZACZ0017-13 or similar.
- 3 With the block valve (1) closed, hydrostatic pressure test at 300 lbs/in² for one minute without leakage.
- 4 Replace the tank unit, fitting 1/4 inch UNF plug and Dowty sealing washer in place of the pressure relief/bleed valve (3).
- 5 With the block valve open, hydrostatic pressure test at 300 lbs/in² for one minute without leakage
- 6 Release the pressure to atmosphere, close the block valve and replace the pressure relief/bleed valve.
- 7 With block valve open, gradually increase pressure until the pressure relief/bleed valve operates. This should occur at 200lbs/in² ± 5lbs/in².
- 8 Reduce pressure to 180lbs/in² and close the block valve. In this condition, carefully open the pressure relief/bleed valve by pulling its spindle outwards thus releasing the pressure in the tank unit to atmosphere. Couple and uncouple the 1/2 in hose unit.
- 9 Refit the pressure relief valve (5). Close the block valve (1) and gradually increase the pressure until the pressure relief valve (5) operates. This should occur at 200lb/in² ± 5lb/in².

CAUTION

Ensure that the block valve (1) is fully closed before operating the pressure relief/bleed valve (3).
 THE BALL VALVE MUST BE KEPT FULLY CLOSED AT ALL TIMES, EXCEPT DURING SAMPLING OPERATIONS.