



**STANDARD SPECIFICATION:**

Patented venturi type automatic shut-off with safety cut-out attitude valve. Built-in check valve. 3-speed lever latch with removable latch pin EB 280. Swivel hose inlet DN 32 with self lubricated ball bearing. Black plastic cover. Body, spout and guard of aluminium. Internal parts and swivel of bronze and hot stamed brass. Steel parts galvanized and chromated. Poppet of acetal resin. Seals of NBR / polyurethane.

Weight ≈ 2,5 kg

Meets requirements of EN 13012. ATEX category EX II 1G, all European regulations for weights and measures and TRbF 513 - German type approval: PTB No. III B/S 1873

1

R 1 1/2" AG  
1 1/2" BSP male

ZVA 32.1

R 1 1/4" IG  
1 1/4" BSP female

ZVA 32.14

2

R 1 1/2" AG  
1 1/2" BSP male

ZVA 32.2

R 1 1/4" IG  
1 1/4" BSP female

ZVA 32.24

3

R 1 1/2" AG  
1 1/2" BSP male

ZVA 32.3

R 1 1/4" IG  
1 1/4" BSP female

ZVA 32.34

4

R 1 1/2" AG  
1 1/2" BSP male

ZVA 32.4

R 1 1/4" IG  
1 1/4" BSP female

ZVA 32.44

1 1/4" NPT IG  
1 1/4" NPT female

(ZVA 32.45)

6

R 1 1/2" AG  
1 1/2" BSP male

ZVA 32.6

R 1 1/4" IG  
1 1/4" BSP female

ZVA 32.64

6B

R 1 1/2" AG  
1 1/2" BSP male

ZVA 32.6 B

R 1 1/4" IG  
1 1/4" BSP female

ZVA 32.6 B 4

HIFLO-Automatic nozzle DN 32 (1 1/4"), flow rate up to 200 litres/min. Working pressure 0,5 - 6 bar. - For gasoline, diesel, fuel oil, petroleum, Avgas and Jet-A1. - Not suitable for viscous oils and water (corrosion).

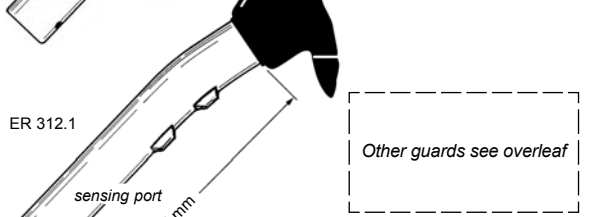
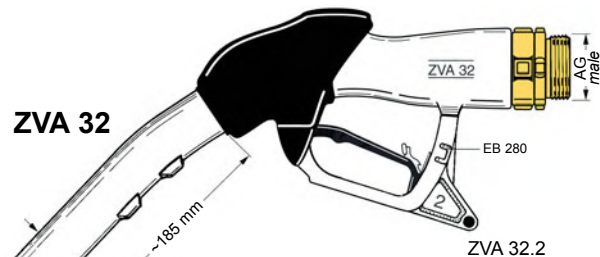

Other guards see overleaf

**Special Types / Accessories**

ZVA 32 with extended spout ER 312.1 for easier refuelling of helicopters, diesel locomotives, tracked vehicles and busses. Foaming is reduced and a higher degree of refuelling is achieved.

ZVA 32 ... ER

ZVA 32 special type for cold regions, with PTFE-coated diaphragm assembly EA 151 TD and EO 271 PU of polyurethane.

ZVA 32 ... LT

ZV 32 (ZVA 32 without automatic shut-off in special version with "Renk" coupling for the refuelling of railroad locomotives.

ZV 32 ... DB

ZV 32 DB, as mentioned above, additionally with Safety Break SSB 32 and BT 32 break cover, see overleaf.

ZV 32 ... DB + SSB

Screen 100 mesh, polyamide, for aviation fuel and Jet-A1.

ES 316.1

Dust cap assembly: NBR/brass. For spout ZVA 32 (39 mm OD)

GKG 32

Ground cable assy. with brass clamp, wire plastic coated. 1200 mm lg.

EKG 1200

Spout with Jet A1 adapter

ER 312 JET

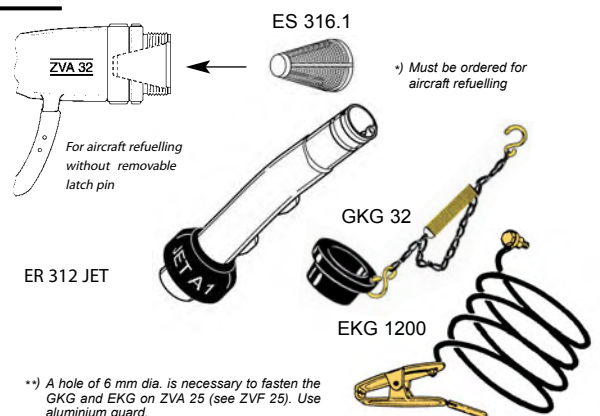
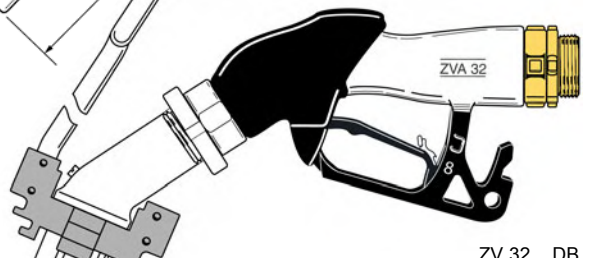

\*\* ) A hole of 6 mm dia. is necessary to fasten the GKG and EKG on ZVA 25 (see ZVF 25). Use aluminium guard.

Specifications subject to change without notice · Copyright ELAFLEX